

## Escape Plan

Look at this plan of a house.

### Remember

Get out

Call the Fire and Rescue Service out

**999**

Stay out!

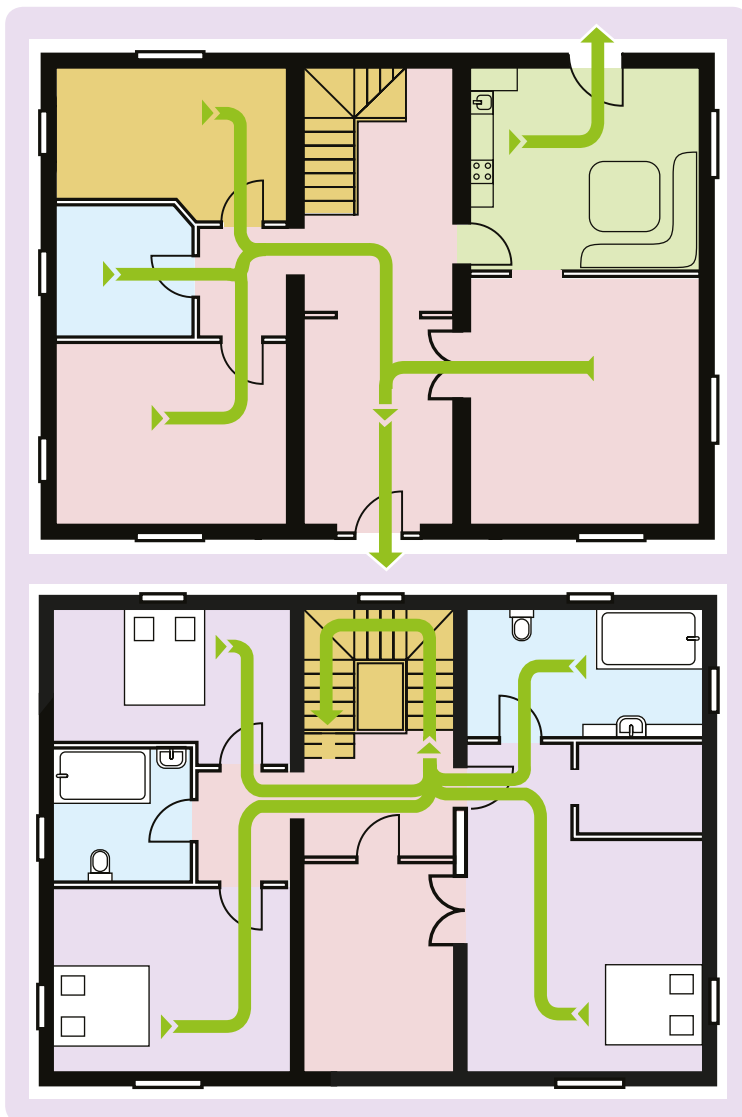

Downstairs

Escape route



### Bedtime Routine

Put a guard around coal and log fires

Switch off and pull out all plugs that are not in use

Don't leave your mobile phone/tablet charging overnight

Close all doors to protect escape routes

Upstairs





## Escaping from your home

Draw a plan of your house below. Remember to show the escape routes.

Why is an Escape Plan important?

Downstairs

Upstairs

